

DO NOT SCALE

THIRD ANGLE PROJECTION

TO BE FREE OF ALL BURRS

DIMENSIONS IN MM

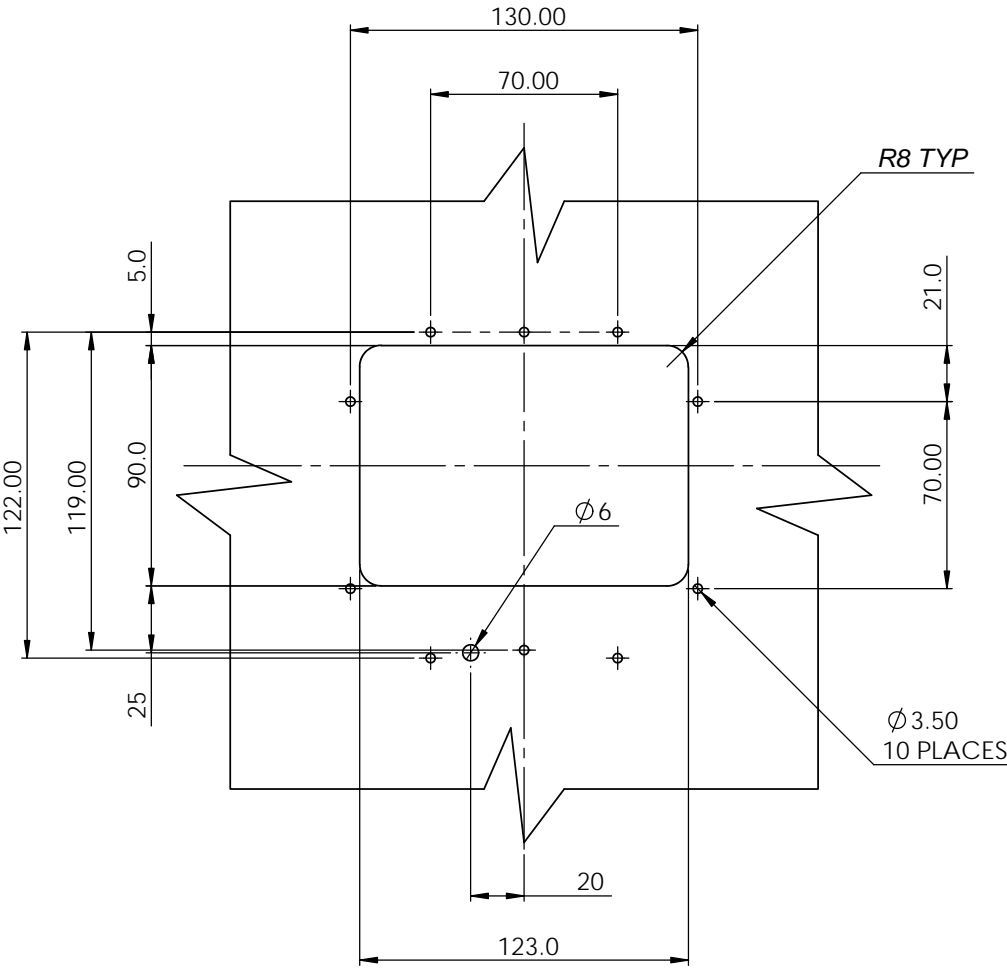

MID-PLANE HOUSING IS DESIGNED TO BE SECURED WITH EIGHT M3 SELF TAPPING SCREWS. FOR SCREW LENGTHS SEE TABLE BELOW.

PLEASE ENSURE THAT A SUITABLE PANEL MATERIAL IS USED TO SUPPORT THE KEYPAD. THIS MUST PROVIDE SUFFICIENT RIGIDITY WHERE SEALING IS REQUIRED. E.G. 1.5mm TO 2.0mm STEEL. THE UNDERSIDE OF THE PANEL SHOULD BE FLAT, CLEAN & FREE OF DEBRIS TO OPTIMISE SEALING. THE TORQUE APPLIED TO THE SCREWS SHOULD NOT EXCEED 50cNm.

LOCATION POSTS TWO POSITIONS ENSURE THESE ARE LOCATED BEFORE FITTING SCREWS.

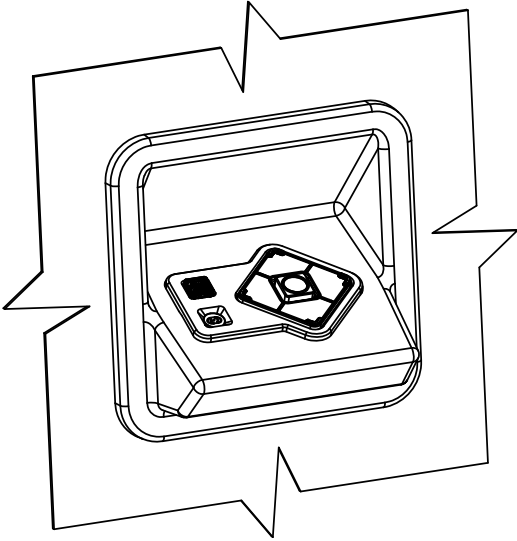

VIEWS SHOWING FRONT AND REAR OF PANEL WITH FIXING POSITIONS.

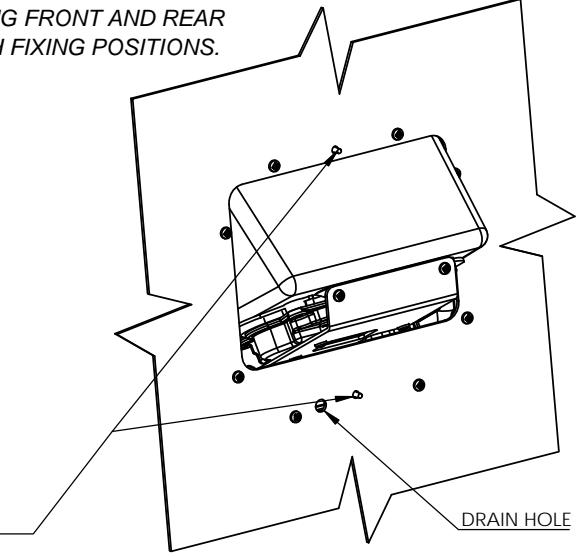

DRAIN HOLE

ECN	REV	CREATED	APP	DATE
ECN101921	1	AC		

PANEL THICKNESS	SCREW LENGTH
1.5 mm	6 mm
2.0 mm	6 mm
3.0 mm	8 mm
4.0 mm	8 mm



Storm Interface  
1 Waterside Court,  
Waterside Drive,  
Langley,  
Berkshire,  
SL3 6EZ, England

tel: +44 (0) 1895 431421  
email: sales@storm-interface.com  
website: www.storm-interface.com

Drawing Status	Description	MOUNTING PLATE FOR ANGLED AUDIONAV			
Drawn By & Date	Material	1.5mm STAINLESS STEEL - GRADE 304			
Checked By & Date	Finish				
Approved By & Date	Unless Stated Tolerances	0=±	0.0=± 0.2	0.00=± 0.1	Angle Tol. 0±
	Scale	Tool No.	Weight	Sheet	1 of 1
© Keymat Technology Ltd. The content of this communication and/or document, including but not limited to images, specifications, designs, concepts and information is confidential and is not to be used for any purpose or disclosed to a third party without the express and written consent of Keymat Technology Ltd. Copyright 2024. All rights reserved.		Part No. 170-00-33		Issue 1	